

# New main office for Carlsberg

Main contract for the Carlsberg Group's new headquarters

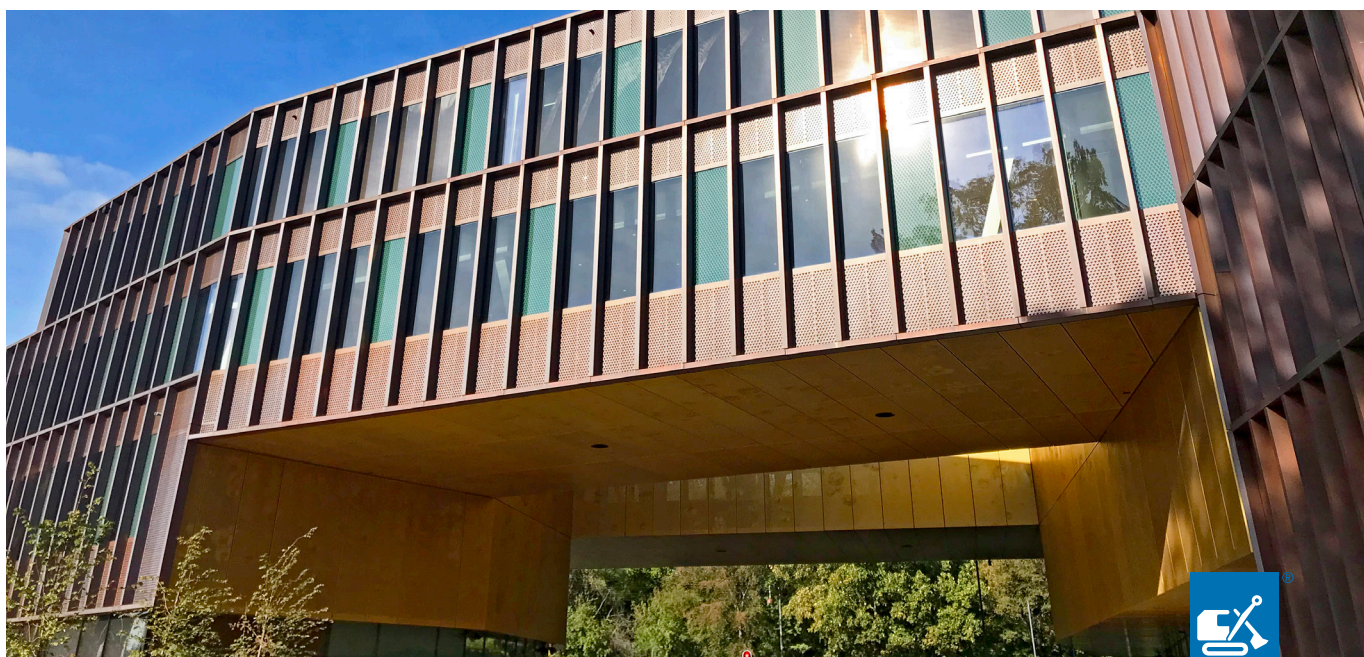

**AARSLEFF**

The Carlsberg City has been transformed to a brand new urban district over the past years. Numerous buildings have been constructed for both residential and commercial purposes, including a new main office for the Carlsberg Group, located at the outskirts of the Carlsberg City district. Working together with our sister company, Wicotec Kirkebjerg A/S, Per Aarsleff A/S has delivered the 15,500-square-metre headquarters for Carlsberg A/S, who wanted to gather a number of business units under the same roof. The new office is a four-storey building with a 7,700 square-metre underground parking garage.

Aarsleff delivered the construction of the office building under a main contract, carrying out work for the shell structure and construction pit as in-house production. Aarsleff's sister company, Wicotec Kirkebjerg A/S, delivered the technical installation work such as electricity, plumbing and ventilation.

#### **Extensive in-house production**

In-house production work for the construction pit included: Excavation and handling of soil, inclu-

ding contaminated soil, sewer work and foundation work. Aarsleff's ground engineering specialists used diaphragm walls to reduce noise and vibrations. They installed the diaphragm walls by excavating a 22-metre-deep trench in the construction pit while pumping a special cement mixture into the trench. A mixture containing bentonite, which is a plastic type of clay. Next, the sheet piles were installed and secured. The properties of the bentonite helped to reduce the flow of groundwater into the underground parking garage and the basement.

Aarsleff was also responsible for all the concrete work, including the concrete work for the shell structure. We also delivered various element installation work for the shell structure. The new office construction consists of two buildings connected by indoor steel bridges and a tunnel. What is more, work included construction of terraces and garden areas. The entire project was carried out according to a very tight schedule, so planning and coordination were key throughout the project life cycle.

[www.aarsleff.com](http://www.aarsleff.com)

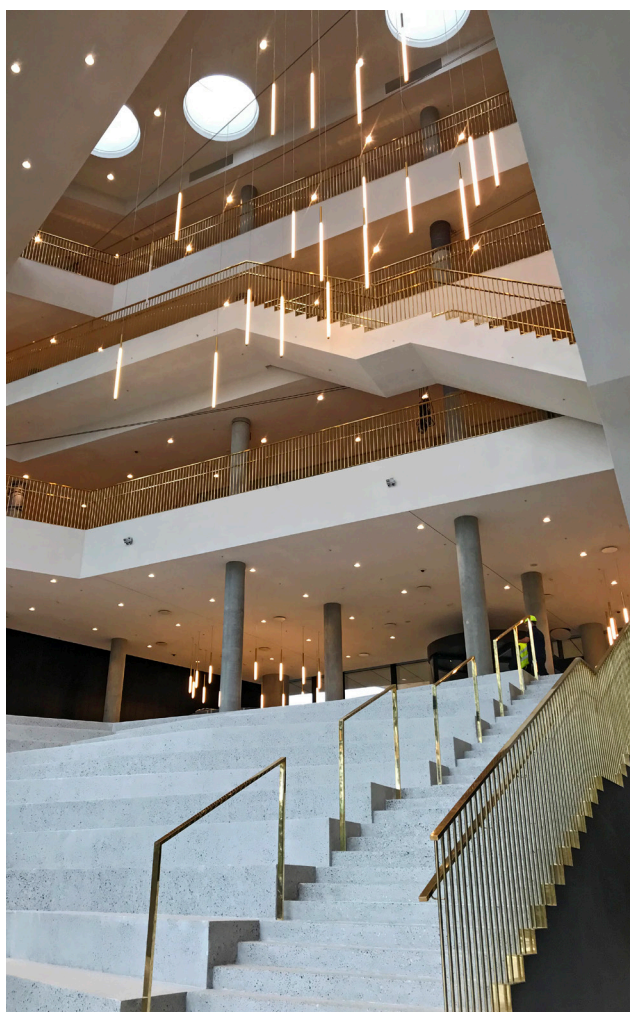

#### Data

- Approx. 15,500 m<sup>2</sup> of office space
- 4 storeys
- Approx. 7,700 m<sup>2</sup> of underground parking facilities

#### Client

Carlsberg A/S

#### Contractor

Per Aarsleff A/S

#### Cooperation partner

Wicotec Kirkebjerg A/S

#### Type of contract:

Main contract

#### Consulting engineer/

#### Architect

Niras A/S (consulting engineer)

C. F. Møller A/S (architect)

Rambøll Danmark A/S (site management and coordination of health and safety)  
EKJ Rådgivende Ingeniører A/S (client's consultant)

#### Construction period:

February 2017 – October 2019

#### Contact

Per Aarsleff A/S  
Construction  
Estimation & Tender  
kalkulation@arsleff.com  
Tel. +45 8744 2222

ANLÆG-233-rev.3 06/2023